

过渡接头 ADAPTER

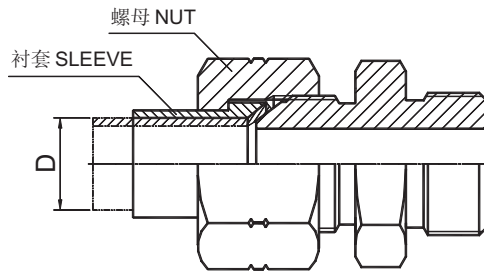
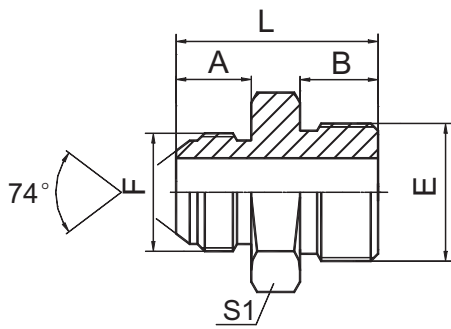

1JB-F

美制 JIC 外螺纹 74° 外锥 / 英管外螺纹平面
 JIC MALE 74° CONE/BSP MALE FLAT-FACE

代号 PART NO.	螺纹 THREAD		尺寸 DIMENSIONS					
	E	F	A	B	L	S1		
1JB-06F	9/16"X18	G3/8"X19	14.1	11.5	31.6	19		
1JB-08F	3/4"X16	G1/2"X14	16.7	14	38.7	22		
1JB-10F	7/8"X14	G5/8"X14	19.3	14.5	41.8	24		
1JB-12F	1.1/16"X12	G3/4"X14	21.9	15.5	47.4	30		

注：螺母及衬套需另行订货。管子直径 D 为公制时，配用螺母及衬套分别选用 NB200、NB500。管子直径为英制时，配用螺母及衬套分别选用 NB200、NB300。 Nut and sleeve should be ordered separately. The nut NB200 and sleeve NB500 is suitable for metric tube, the nut NB200 and sleeve NB300 is suitable for inch tube.